



ASSESSMENT MAP
 County of Blair
 Pennsylvania
 Date Published: 1/24/2023

The County makes no guarantee or warranty to its accuracy as to labeling, dimensions, placement or location of any features contained herein. The boundaries depicted by this data are approximate, and are not necessarily accurate to surveying or engineering standards. This data is intended for informational purposes and should not be considered authoritative for engineering, navigational, legal and other site-specific uses.

Presented by:
 Blair County Assessment Office
 423 Allegheny St, Suite 041
 Hollidaysburg, PA 16648

Prepared by:
 Blair County GIS Department
 423 Allegheny St, Suite 011
 Hollidaysburg, PA 16648

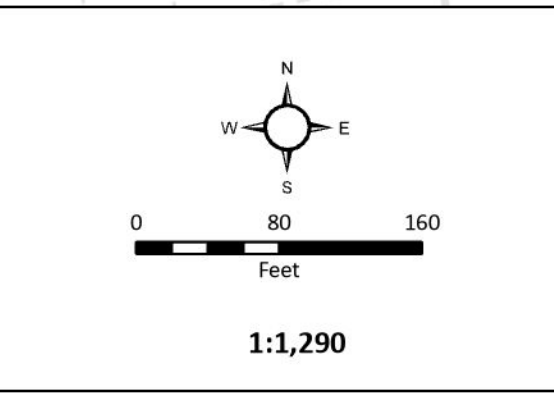

- Auxiliary Assessment Map Lines**
- Match Sheets
 - Assessment_LGHM.DBO.Parcels
 - Tax Parcels
 - Ward Boundary
 - Municipal Boundary
 - Rights of Way (200)
 - Boundary Type
 - Private Road
 - Rail ROW
 - Road ROW
- Parcel & Easement Lines (200)**
- Boundary Type
 - Parcel Boundary
 - Lot Lines
 - Easements
 - Water Bodies
 - Rivers and Streams
 - Sheet Parcels



REVISIONS

No.	Description	Date

ROARING SPRING BOROUGH
 District: 18.00
 Map #: 04
 (18.00-04..)