

MAP 01.13-16..

MAP 01.13-17..

MAP 01.13-18..

MAP 01.13-27..

MAP 01.13-29..

MAP 14.00-18..

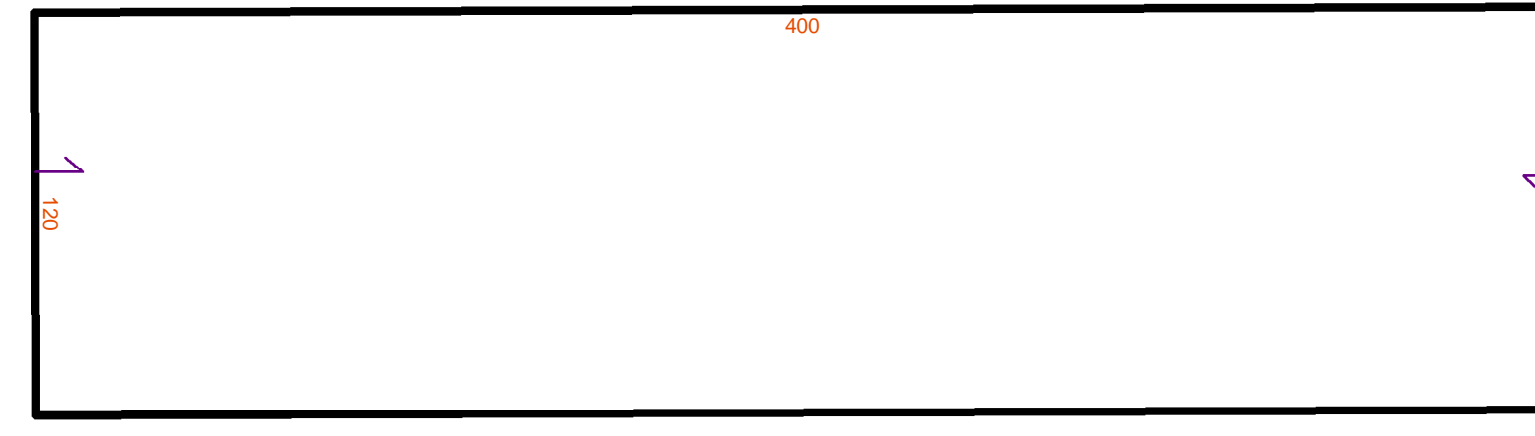
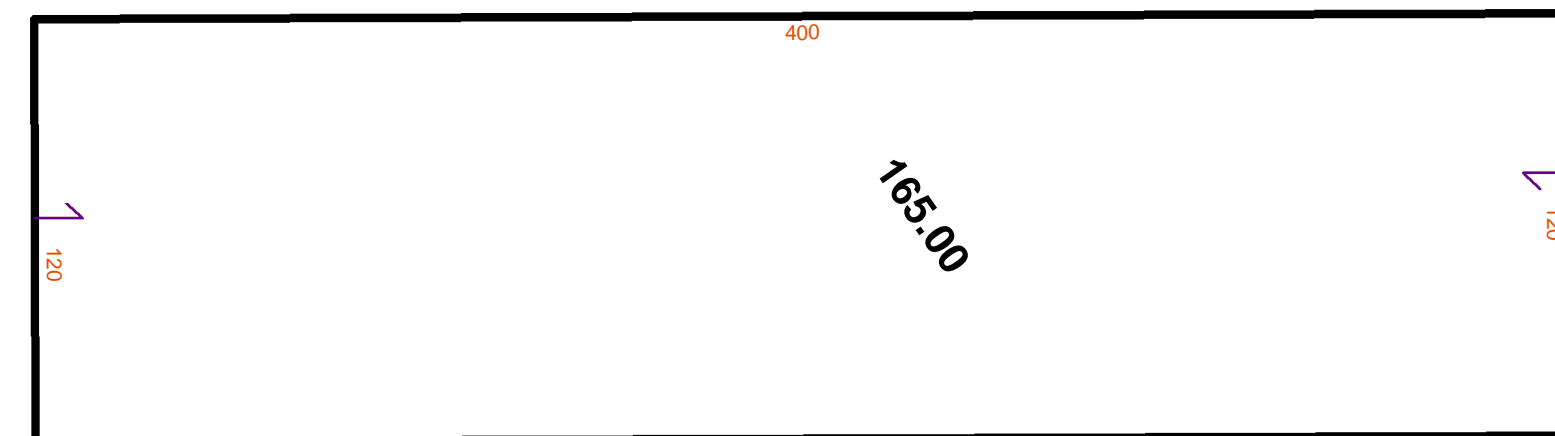
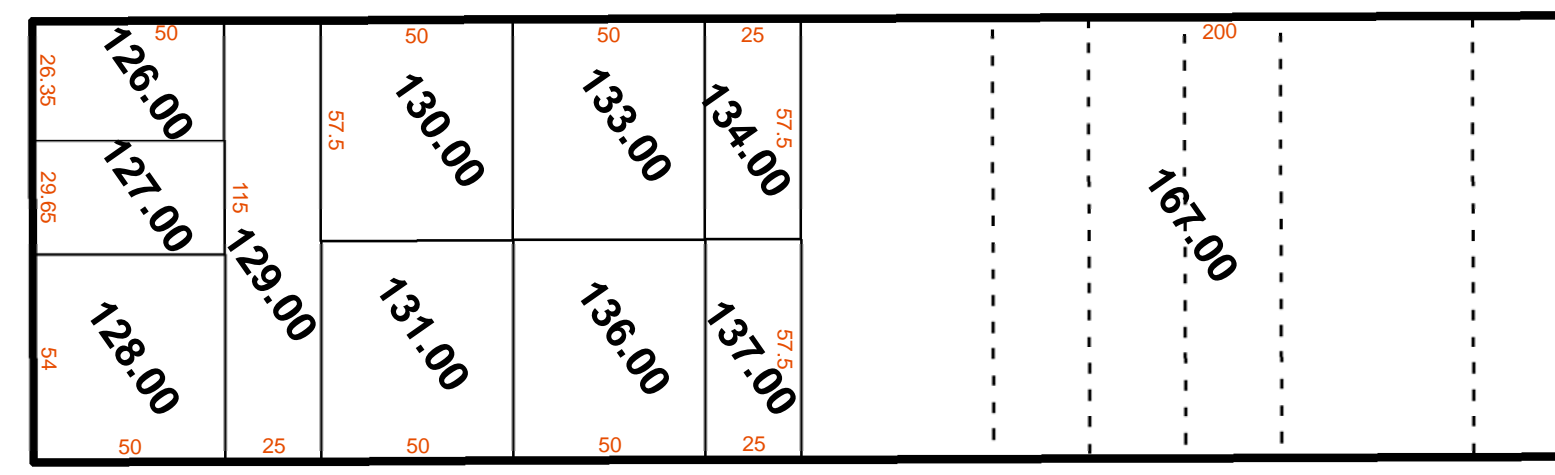
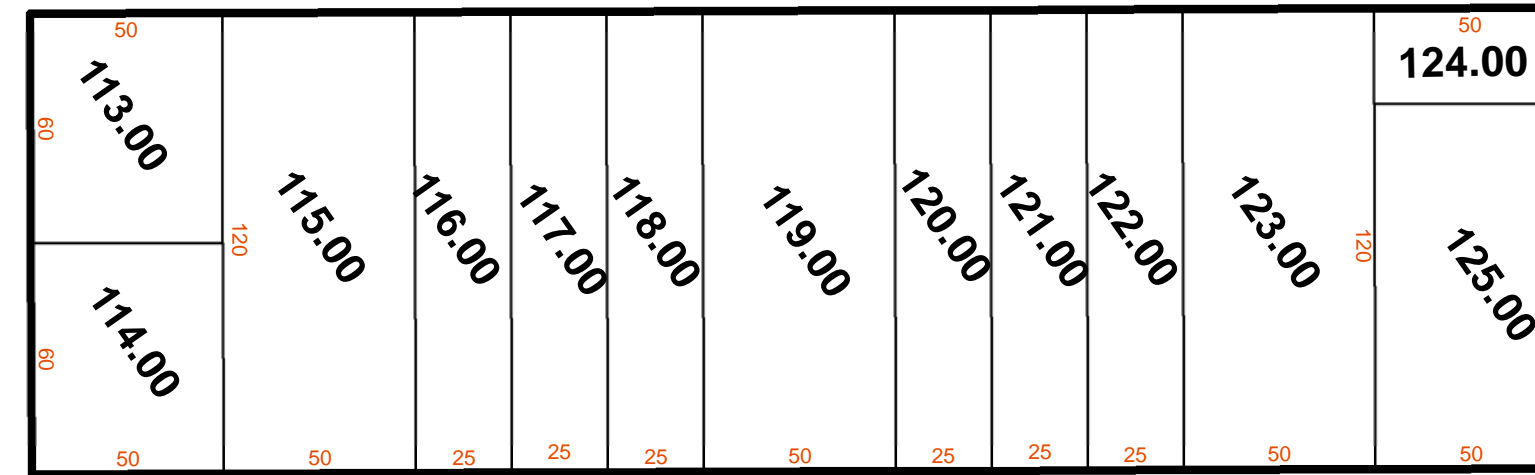
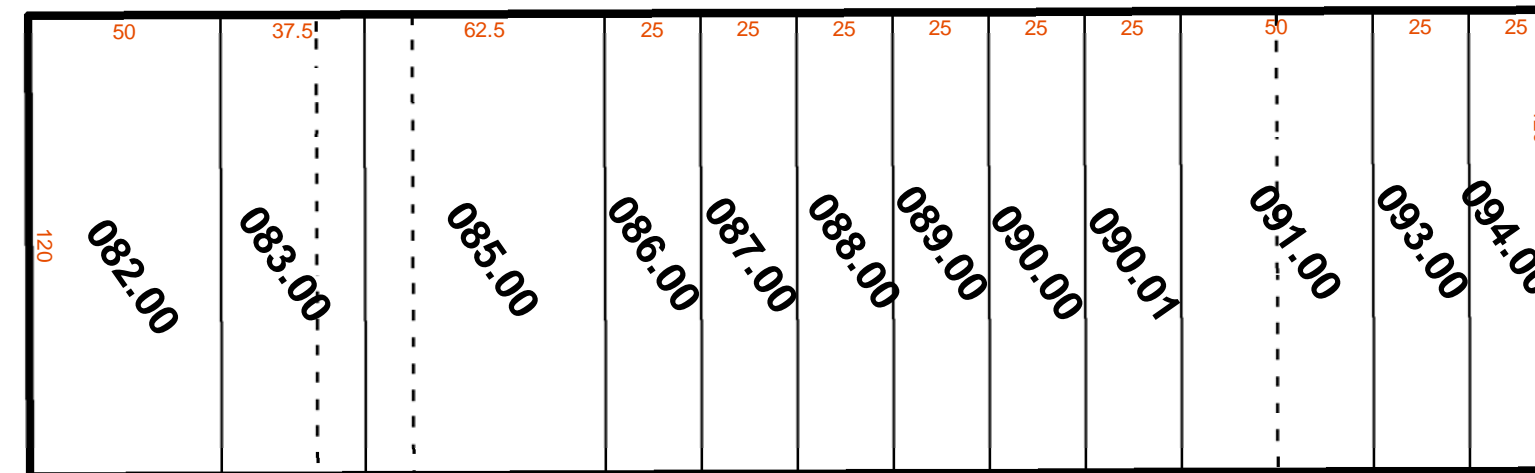
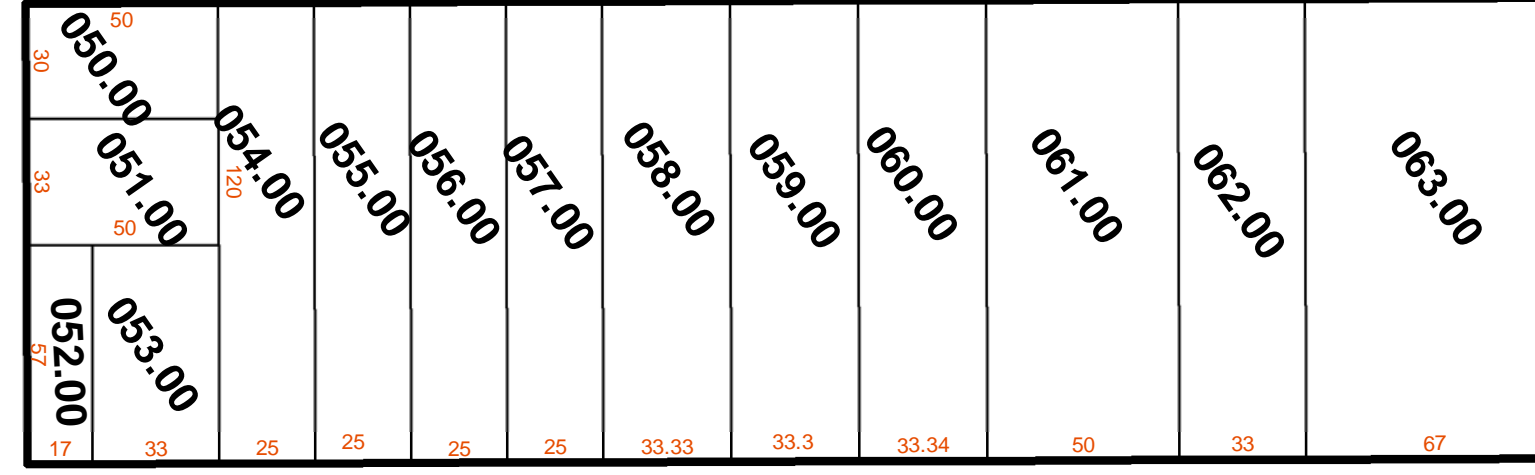
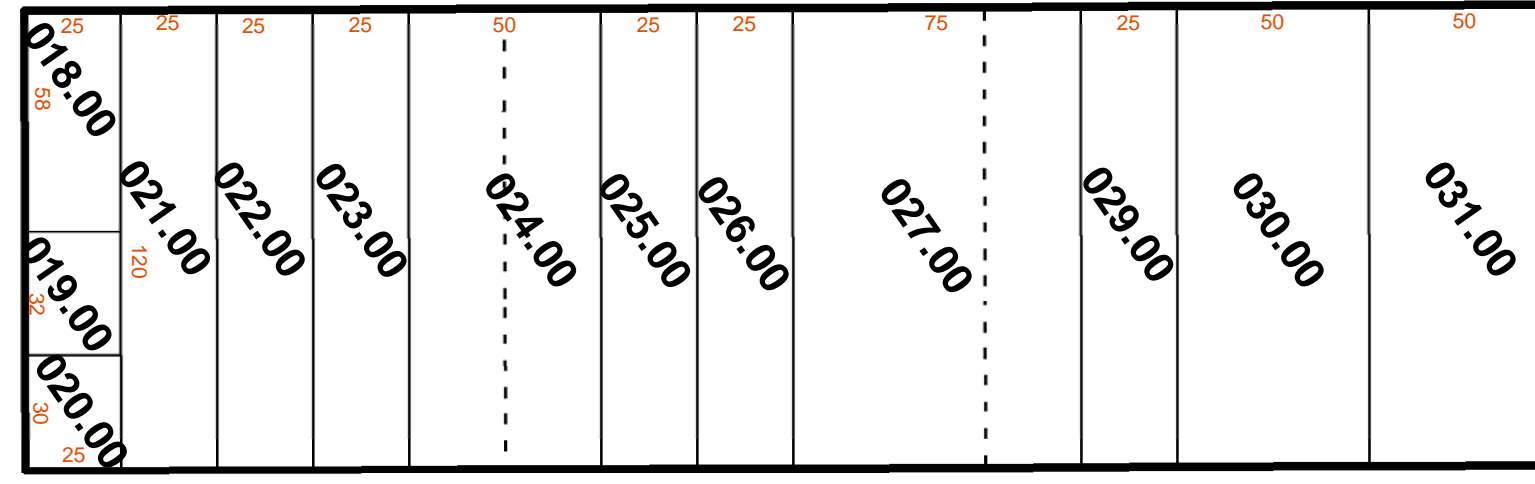
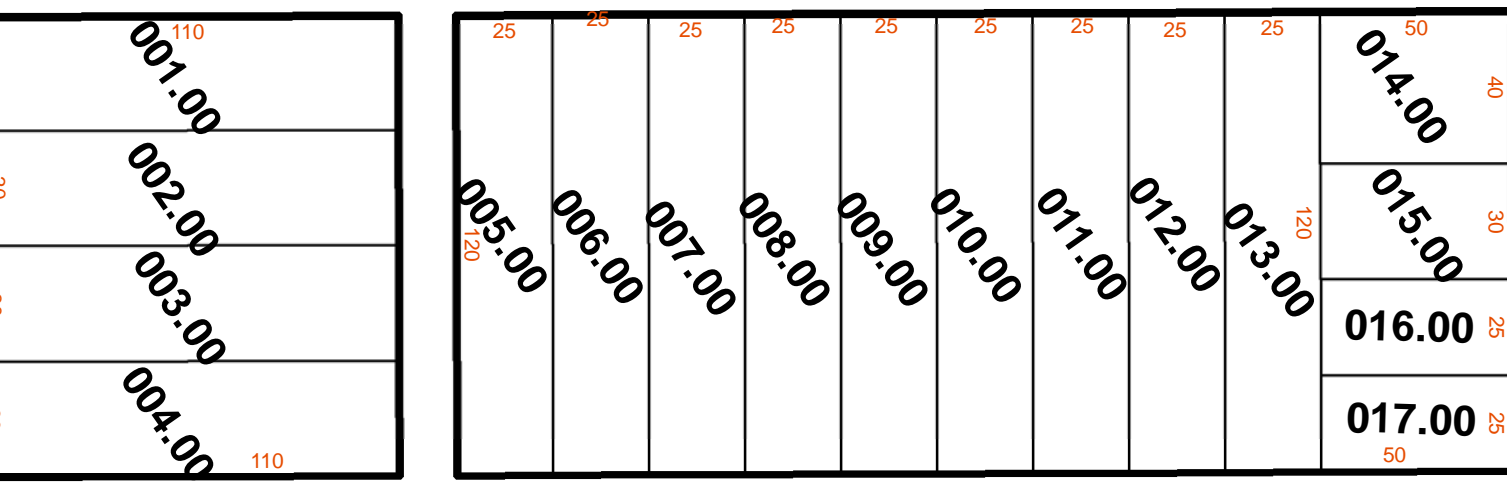

N 2ND ST

N 3RD ST

N 4TH ST

LOGAN TWP

N 4TH AVE

LOGAN TWP

N 5TH AVE

ASSESSMENT MAP

County of Blair
Pennsylvania

Date Published: 7/8/2019

The County makes no guarantee or warranty to its accuracy as to labeling, dimensions, placement or location of any features contained herein. The boundaries depicted by this data are approximate, and are not necessarily accurate to surveying or engineering standards. This data is intended for informational purposes and should not be considered authoritative for engineering, navigational, legal and other site-specific uses.

Presented by:
Blair County Assessment Office
423 Allegheny St, Suite 041
Hollidaysburg, PA 16648
Prepared by:
Blair County GIS Department
423 Allegheny St, Suite 011
Hollidaysburg, PA 16648

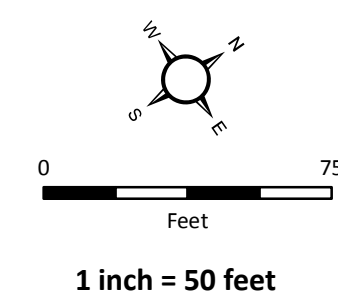

- Road ROW
- Parcel Boundary
- Lot Lines
- Ward Boundary
- Municipal Boundary
- Sheet Parcels

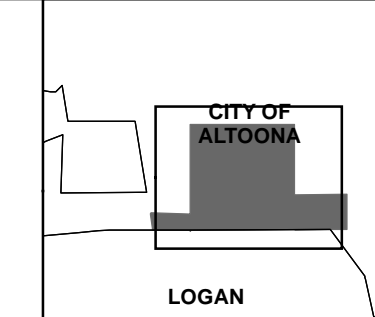

REVISIONS	

CITY OF ALTOONA
District: 01.13
Map #: 28
(01.13-28..)